



# COLUMBIA SHUSWAP REGIONAL DISTRICT

555 Harbourfront Drive NE, PO Box 978, Salmon Arm, BC V1E 4P1  
T: 250.832.8194 | F: 250.832.3375 | TF: 1.888.248.2773 | www.csrld.bc.ca

July 4, 2018

File: DVP 2000-74  
PL2018085

## NOTICE OF DEVELOPMENT VARIANCE PERMIT 2000-74

### What is DVP No. 2000-74?

The owners are requesting setback variances for the existing buildings on the property:

Section 2.12(2)(d) Minimum setback from:

- Interior side parcel boundary from 2 m to 0.05 m for the shed on skids;
- Exterior side parcel boundary from 4.5 m to 2.73 m for the deck attached to an accessory building and to 3.47 m for the single family dwelling;
- Rear parcel boundary from 4.5 m to 0.71 m for the shed on skids, to 0.76 for the shed on cinder blocks, and to 4.42 m for an accessory building.

CIVIC ADDRESS: 643 Swansea Point Road

LEGAL DESCRIPTION: Lot 10, Section 11, Township 21, Range 8, West of the 6<sup>th</sup> Meridian, Plan 13300

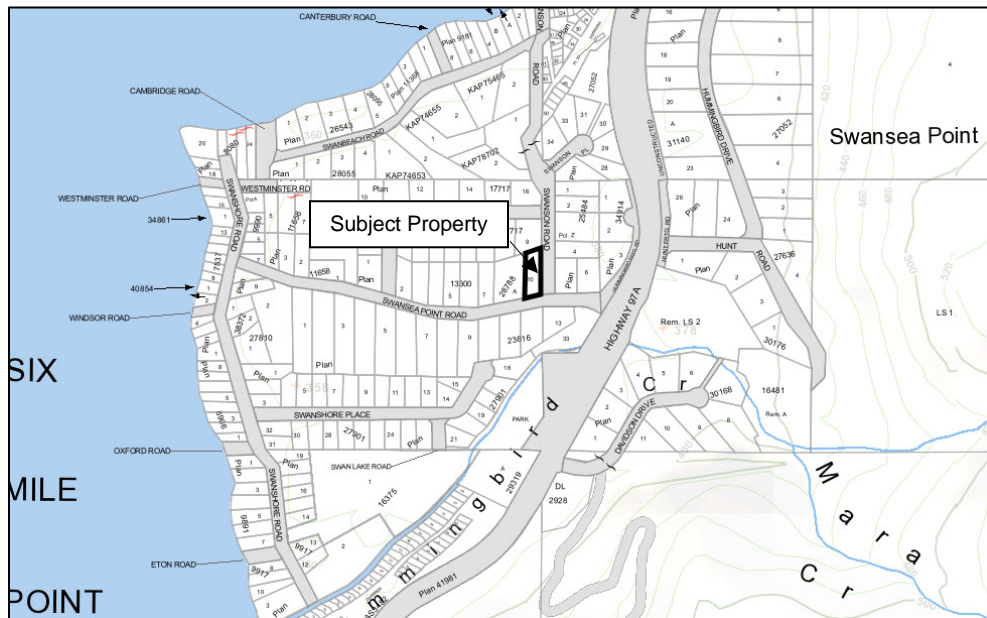

#### ELECTORAL AREAS

A GOLDEN-COLUMBIA  
B REVELSTOKE-COLUMBIA

C SOUTH SHUSWAP  
D FALKLAND-SALMON VALLEY

E SICAMOUS-MALAKWA  
F NORTH SHUSWAP-SEYMOUR ARM

#### MUNICIPALITIES

GOLDEN  
REVELSTOKE

SALMON ARM  
SICAMOUS

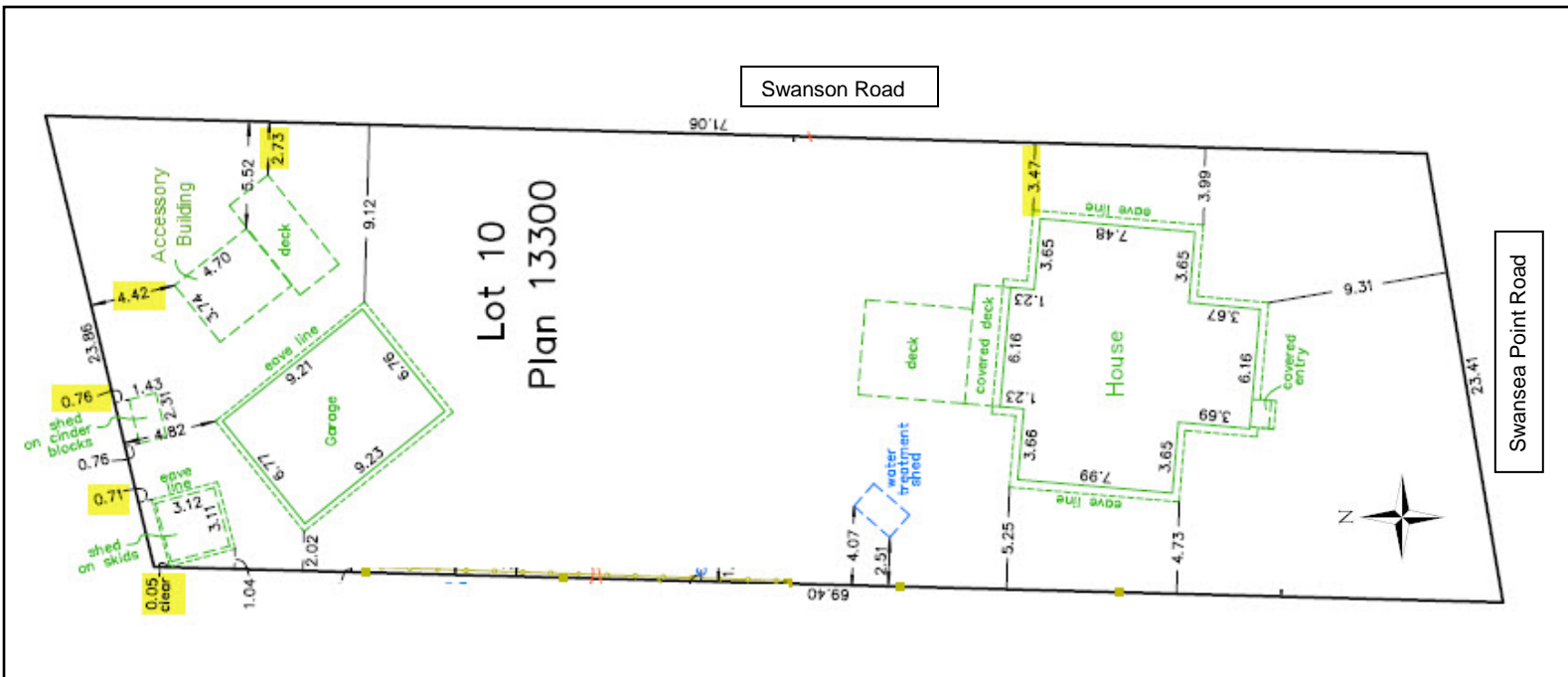

**How can I find out more about this permit application?**

A copy of the proposed permit application and relevant background documents may be inspected at the Columbia Shuswap Regional District (CSRD), 555 Harbourfront Drive NE, Salmon Arm, BC between the hours of 9:00 AM and 4:00 PM, beginning Wednesday, July 4, 2018 and ending Wednesday, July 18, 2018 (excluding Saturdays, Sundays and Statutory holidays); or, contact the staff person listed below.

**How do I send a written submission about this permit application?**

Written submissions will be accepted at the CSRD until 4:00 PM on Tuesday, July 17, 2018. The Board of the CSRD considers the author's name and residential address relevant to the Board's consideration of this matter and should be included in your Submission. The author's phone number and email address are not relevant to the Board's consideration of this matter and should not be included in the written submission. Written submissions received by the CSRD are subject to public disclosure and a copy may be provided to the applicant. Please clearly write "DVP Submission – DVP No. 2000-74" on your submission. Written submissions may be submitted to: [plan@csrd.bc.ca](mailto:plan@csrd.bc.ca) or to the address above.

**Where and when will the permit be considered for issuance?**

At the CSRD, 555 Harbourfront Drive NE, Salmon Arm, BC, during the Regular Board Meeting commencing at 9:30 am on July 19, 2018.

The Board meeting is open for public attendance, however, there is no specific opportunity for the public to provide verbal or written submissions about this permit application at this meeting.

**Who can I contact about this permit application?**

Candice Benner  
250-833-5960  
[cbenner@csrd.bc.ca](mailto:cbenner@csrd.bc.ca)