

CANNABIS NOTIFICATION LETTER AND PROPOSAL TO CSRD

<Company Name>
<Civic Address>
<Phone Number>

January 1st 2019

Columbia Shuswap Regional District
555 Harbourfront Drive NE
PO Box 978
Salmon Arm, BC V1E 4P1

Re: Notice of Application for Micro-Cultivation License - <Civic Address>

To whom it may concern,

This letter is to inform your Planning Department that <Company Name> will be submitting an application to Health Canada on or around January 1st, 2019, to obtain a Micro-Cultivation License for the production of cannabis at <Civic Address>. Please see the attached project proposal, site plan and maps for more details.

Thank you for taking the time to read this notice and review our proposal.

Kind regards,

Signature

Person in Charge
Company Name

cc: Local RCMP Detachment staff Sergeant **INSERT NAME**
Local CSRD Fire Chief **INSERT NAME**

Enclosures: Project Proposal
Site Plans and Maps
Certificate of Title

Project Proposal

- A. Owner : _____ (Both names of registered owners)
Mailing address: _____
- B. Agent/Applicant: _____ (names of applicant and/or agent)
- C. Legal description: _____ (e.g. Legal Subdivision 1, Sec 2, Township 3, Range 4 West of the 6th Meridian)
Civic address: _____
- D. I have attached a certificate of title dated within 30 days
- E. Description of Proposed Facility:
- The license is for the _____ (micro-cultivation, standard cultivation, etc.)
 - Parcel size = ____ ha
 - Total floor area of cultivation building = ____m²
 - The property is currently used for _____ (e.g. Residential, business, farming, etc.)
 - The water source is _____ (e.g. Well, groundwater, community water, etc.)
 - Odour management will be addressed by... (How are you addressing odour from facility)
 - Waste management:
 - Solid waste (soil, stalks, growing medium etc.) generated by the facility will be disposed of by _____ (How are you disposing of waste from the facility)
 - Waste water will addressed by _____ (how are you addressing disposal of waste water)
 - Parking: Parking for no more than ____ vehicles will be on site.
 - Lighting/glare: _____ (How are you addressing the lighting and glare from the facility)
 - Security: _____ (What are your security measures for the facility)
- F. Community impact: There are no foreseen community impacts for the following reasons-

- G. Distance to public facilities: _____ (e.g. There are no day-cares, schools, parks, playgrounds, libraries, or health facilities located within 300 m of our proposed facility or indicate if there is)
- H. Signage: _____ (e.g. there is currently no signage planned or indicate size and location)
- I. Plans/maps:
- Attached site plan showing set-back measurements
 - Attached basic floor plans
 - Ortho Map attached showing that the subject parcel is approx. ____meters away from following public facilities

Example Site Plan (Preferably in Metric):

- North arrow;
- Dimensions and boundaries of property lines, rights-of-way, and easements;
- Location and dimensions of all existing and proposed buildings and structures, and the setbacks to parcel lines, rights-of-ways, easements;

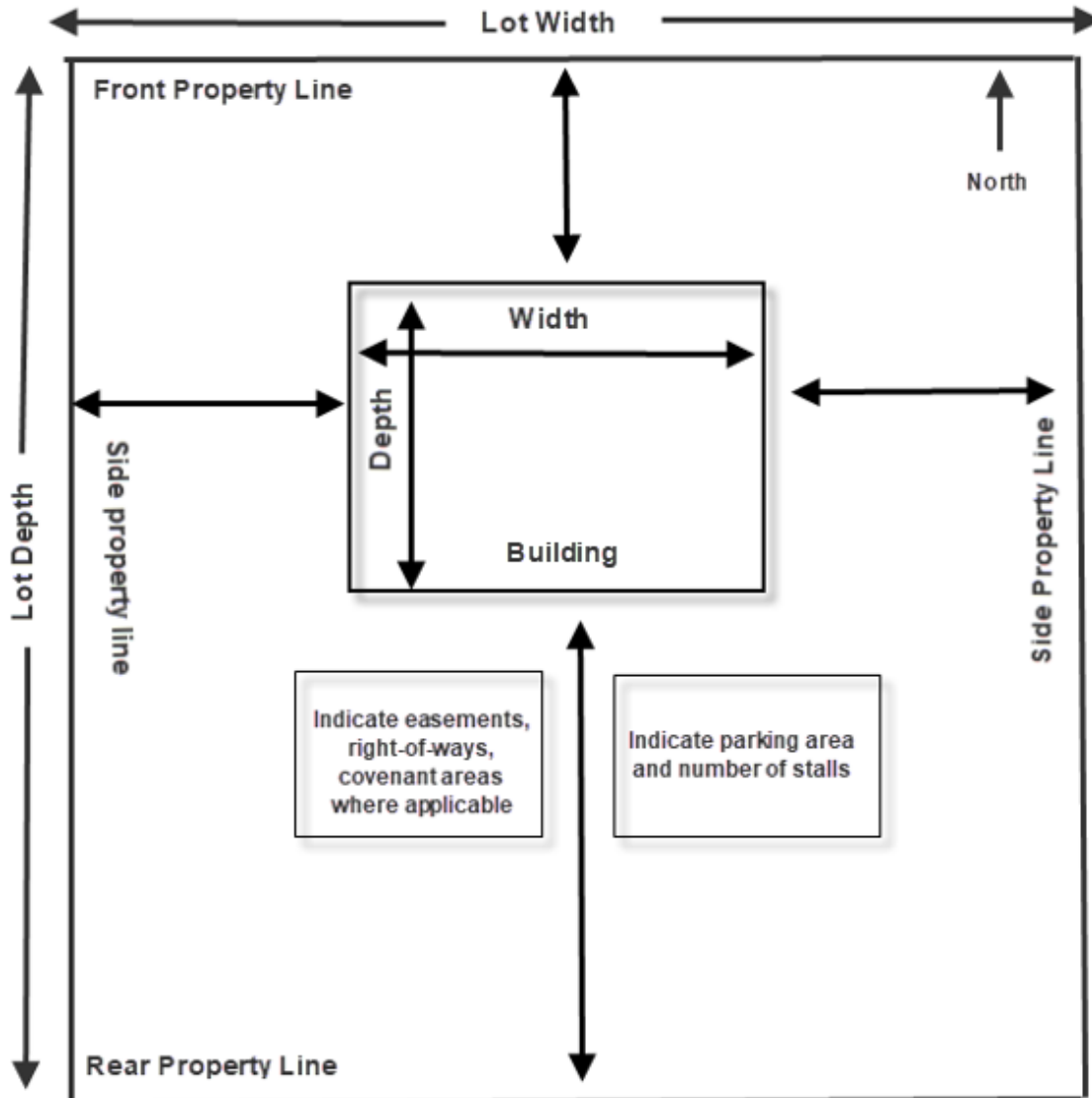

Example Floor Plan (Preferably in Metric):

- Floor area ___m²;
- Showing all rooms and uses

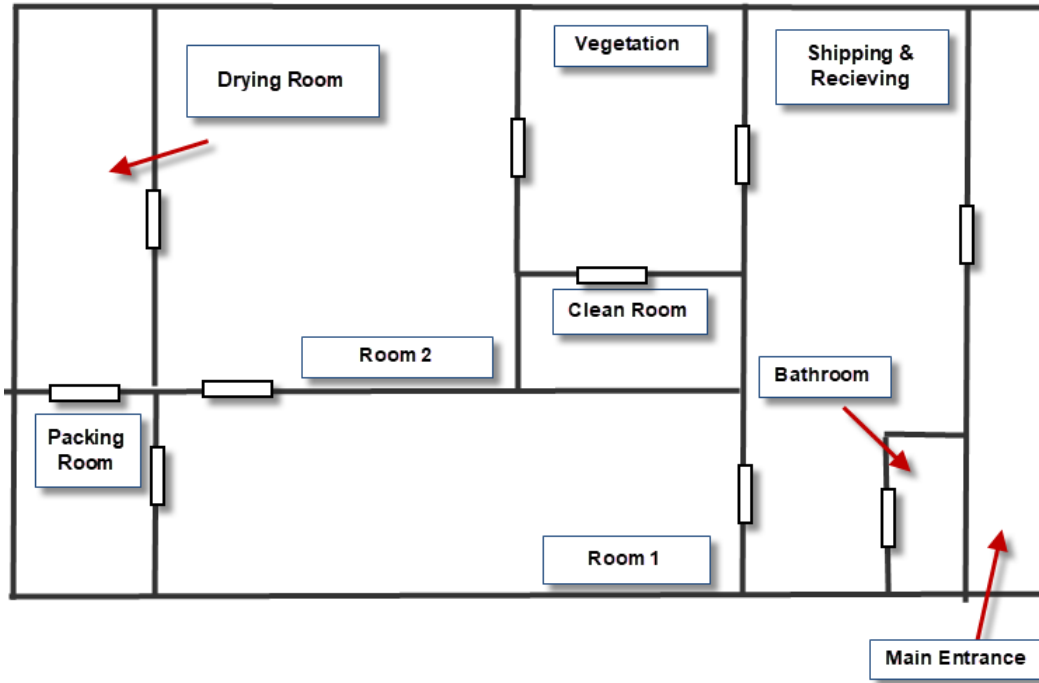

Example Orthographic map:

